

Your Agency



28 Lambton Road Waratah NSW

3 1 2

Offering comfortable living now, this lovely property could well become the home of your dreams. Situated on a large 569sqm corner block, the possibilities are endless. Its central location, close to public transport, Waratah Village, parks, schools and the Mater Hospital make this ideal for the growing family

Price : \$ 460,000

Land Size : 569 sqm

View : <https://www.youragency.net.au/sale/nsw/newcastle-region/waratah/residential/house/5913123>

- * Renovate & extend to suit your needs (STCA)
- * Ample off street parking
- * Convenient location
- * Save money on your power bills, (5.5kw solar panels)
- * New plumbing

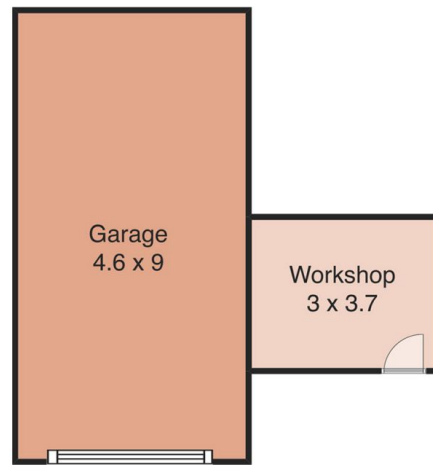
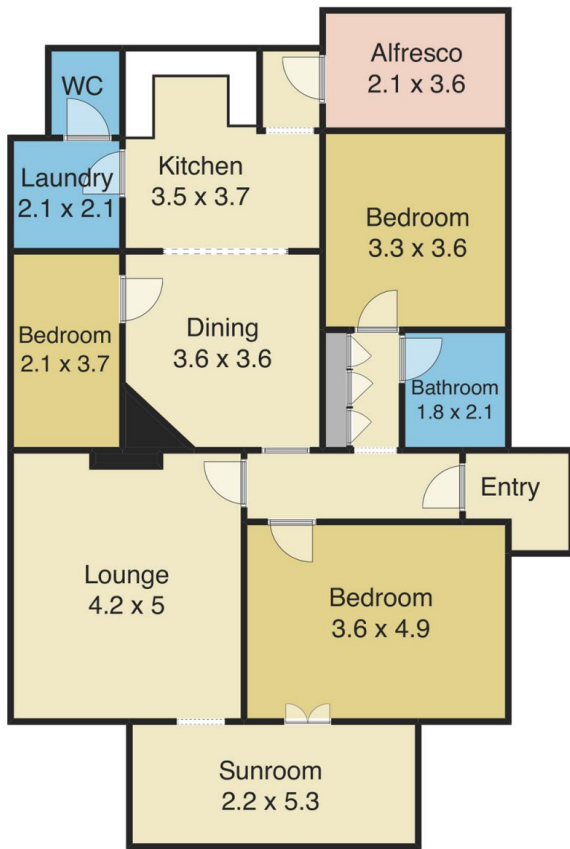

28 Lambton Road, Waratah

Measurements are approximate and are to be used only as a guide